

Steel - 30 x d - rivestito

RACCOMANDAZIONI PER L'USO

● Perfettamente consigliato | ● Consigliato | ○ Parzialmente consigliato | ☒ Non consigliato

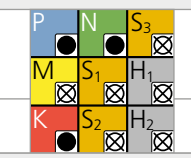

FORARE CON RAFFREDDAMENTO ESTERNO | VISTA D'INSIEME DEI DATI DI TAGLIO

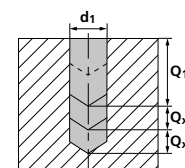
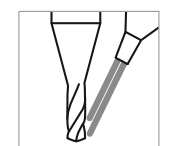

| Gruppo materiali | Materiale | Mat. no. | DIN | AISI/ASTM/UNS | v _c [m/min] | | | | Q ₁ | Q ₂ | f [mm/giro] | | | | | | | |
|-----------------------------------|---|------------------|--------------------|-------------------------|------------------------|------|-----------|------|----------------|----------------|-------------|---------------|---------------|---------------|---------------|-----------------|-------|--|
| | | | | | Ød1 ≤ 0.4 | | Ød1 > 0.4 | | | | 0.2 mm | 0.3 mm | Ød1 | | 0.8 mm | 1.0 mm - 1.2 mm | | |
| | | | | | Medio | Alto | Medio | Alto | | | f | f | 0.4 mm 1/64" | 0.6 mm | 1/32" | f | | |
| P | Acciai non legati Rm < 800 N/mm ² | 1.0301 | C10 | AISI 1010 | | | | | | | | | | | | | | |
| | | 1.0401 | C15 | AISI 1015 | | | | | | | | | | | | | | |
| | | 1.1191 | C45E/CK45 | AISI 1045 | | 5 | 40 | 40 | 60 | 2xd1 | 0.5xd1 | 0.005 | 0.010 | 0.015 | 0.030 | 0.040 | 0.060 | |
| | | 1.0044 | S275JR | AISI 1020 | | | | | | | | | | | | | | |
| | Acciai debolmente legati Rm > 900 N/mm ² | 1.0715 | 11SMn30 | AISI 1215 | | | | | | | | | | | | | | |
| | | 1.5752 | 15NiCr13 | ASTM 3415 / AISI 3310 | | | | | | | | | | | | | | |
| | | 1.7131 | 16MnCr5 | AISI 5115 | | 5 | 25 | 25 | 50 | 2xd1 | 0.5xd1 | 0.003 - 0.005 | 0.008 - 0.010 | 0.012 - 0.015 | 0.020 - 0.025 | 0.035 | 0.050 | |
| | | 1.3505 | 100Cr6 | AISI 52100 | | | | | | | | | | | | | | |
| | Acciai da utensili fortemente legati Rm < 1200 N/mm ² | 1.7225 | 42CrMo4 | AISI 4140 | | | | | | | | | | | | | | |
| | | 1.2842 | 90MnCrV8 | AISI O2 | | | | | | | | | | | | | | |
| | | 1.2379 | X153CrMoV12 | AISI D2 | | 5 | 20 | 20 | 35 | 2xd1 | 1xd1 | 0.004 | 0.008 | 0.010 | 0.015 | 0.025 | 0.040 | |
| | | 1.2436 | X210CrW12 | AISI D4/D6 | | | | | | | | | | | | | | |
| M | Acciai inossidabili ferritici | 1.4016 | X6Cr17 | AISI 430 / UNS S43000 | | | | | | | | | | | | | | |
| | | 1.4105 | X6CrMoS17 | AISI 430F | | | | | | | | | | | | | | |
| | Acciai inossidabili martensitici | 1.4034 | X46Cr13 | AISI 420C | | | | | | | | | | | | | | |
| | | 1.4112 | X90CrMoV18 | AISI 440B | | | | | | | | | | | | | | |
| | Acciai inossidabili martensitici - PH | 1.4542 | X5CrNiCuNb 16-4 | AISI 630 / ASTM 17-4 PH | | | | | | | | | | | | | | |
| | | 1.4545 | X5CrNiCuNb 15-5 | ASTM 15-5 PH | | | | | | | | | | | | | | |
| | Acciai inossidabili austenitici | 1.4301 | X5CrNi 18-10 | AISI 304 | | | | | | | | | | | | | | |
| | | 1.4435 | X2CrNiMo 18-14-3 | AISI 316L | | | | | | | | | | | | | | |
| 1.4441 | | X2CrNiMo 18-15-3 | AISI 316LM | | | | | | | | | | | | | | | |
| K | Ghise | 0.6020 | GG20 | ASTM 30 | | | 50 | 100 | | | | | | | | | | |
| | | 0.6030 | GG30 | ASTM 40B | | | | | | | | | | | | | | |
| | | 0.7040 | GGG40 | ASTM 60-40-18 | | 5 | 40 | 40 | 80 | 2xd1 | 1xd1 | 0.005 | 0.010 | 0.015 | 0.020 | 0.035 | 0.050 | |
| | | 0.7060 | GGG60 | ASTM 80-60-03 | | | | | | | | | | | | | | |
| N | Leghe d'alluminio battute | 3.2315 | AlMgSi1 | ASTM 6351 | | | | | | | | | | | | | | |
| | | 3.4365 | AlZnMgCu1.5 | ASTM 7075 | | 5 | 40 | 60 | 120 | 2xd1 | 1xd1 | 0.015 | 0.040 | 0.050 | 0.080 | 0.100 | 0.120 | |
| | Leghe d'alluminio pressofuse | 3.2163 | GD-AlSi9Cu3 | ASTM A380 | | | | | | | | | | | | | | |
| | | 3.2381 | GD-AlSi10Mg | UNS A03590 | | 5 | 40 | 50 | 80 | 2xd1 | 1xd1 | 0.015 | 0.040 | 0.050 | 0.080 | 0.100 | 0.120 | |
| | Rame | 2.004 | Cu-OF / CW008A | UNS C10100 | | | | | | | | | | | | | | |
| | | 2.0065 | Cu-ETP / CW004A | UNS C11000 | | | | | | | | | | | | | | |
| | Ottoni senza piombo | 2.0321 | CuZn37 CW508L | UNS C27400 | | | | | | | | | | | | | | |
| | | 2.036 | CuZn40 CW509L | UNS C28000 | | | | | | | | | | | | | | |
| | Ottoni, Bronzi Rm < 400 N/mm ² | 2.0401 | CuZn39Pb3 / CW614N | UNS C38500 | | | 60 | 100 | | | | | | | | | | |
| | | 2.102 | CuSn6 | UNS C51900 | | 5 | 40 | 40 | 60 | 2xd1 | 1xd1 | 0.010 | 0.030 | 0.040 | 0.060 | 0.080 | 0.100 | |
| Bronzi Rm < 600 N/mm ² | 2.0966 | CuAl10Ni5Fe4 | UNS C63000 | | | | | | | | | | | | | | | |
| | 2.096 | CuAl9Mn2 | UNS C63200 | | 5 | 20 | 20 | 40 | 2xd1 | 0.5xd1 | 0.004 | 0.006 | 0.010 | 0.015 | 0.025 | 0.040 | | |
| S ₁ | Super leghe | 2.4856 | | Inconel 625 | | | | | | | | | | | | | | |
| | | 2.4668 | | Inconel 718 | | | | | | | | | | | | | | |
| | | 2.4617 | NiMo28 | Hastelloy B-2 | | | | | | | | | | | | | | |
| | | 2.4665 | NiCr22Fe18Mo | Hastelloy X | | | | | | | | | | | | | | |
| S ₂ | Titanio puro | 3.7035 | Gr.2 | ASTM B348 / F67 | | | | | | | | | | | | | | |
| | | 3.7065 | Gr.4 | ASTM B348 / F68 | | | | | | | | | | | | | | |
| S ₃ | Leghe di titanio | 3.7165 | TiAl6V4 | ASTM B348 / F136 | | | | | | | | | | | | | | |
| | | 9.9367 | TiAl6Nb7 | ASTM F1295 | | | | | | | | | | | | | | |
| H ₁ | Acciai temprati < 55 HRC | 1.2510 | 100MnCrMoW4 | AISI O1 | | | | | | | | | | | | | | |
| | | 1.2379 | X153CrMoV12 | AISI D2 | | | | | | | | | | | | | | |

Consiglio: CrazyDrill Flex SST-Inox 30 x d1

Consiglio: CrazyDrill Flex Titanium 30 x d1

Consiglio: CrazyDrill Flex SST-Inox 30 x d1

Consiglio: CrazyDrill Flex SST-Inox 30 x d1

Consiglio: CrazyDrill Flex Titanium 30 x d1

Consiglio: CrazyDrill Flex Titanium 30 x d1

Consiglio: CrazyDrill Flex SST-Inox 30 x d1